

SCALE 2 IN. = 1 MILE
DATED 1938

TOWNSHIP 7 S., RANGE 38 E.W. M.

(23)

BAKER COUNTY, OREGON

CHAS. F. METSKER, CIVIL ENGINEER
215 COMMERCE BLDG. PORTLAND, OREGON
530 PACIFIC AVE. TACOMA, WASHINGTON

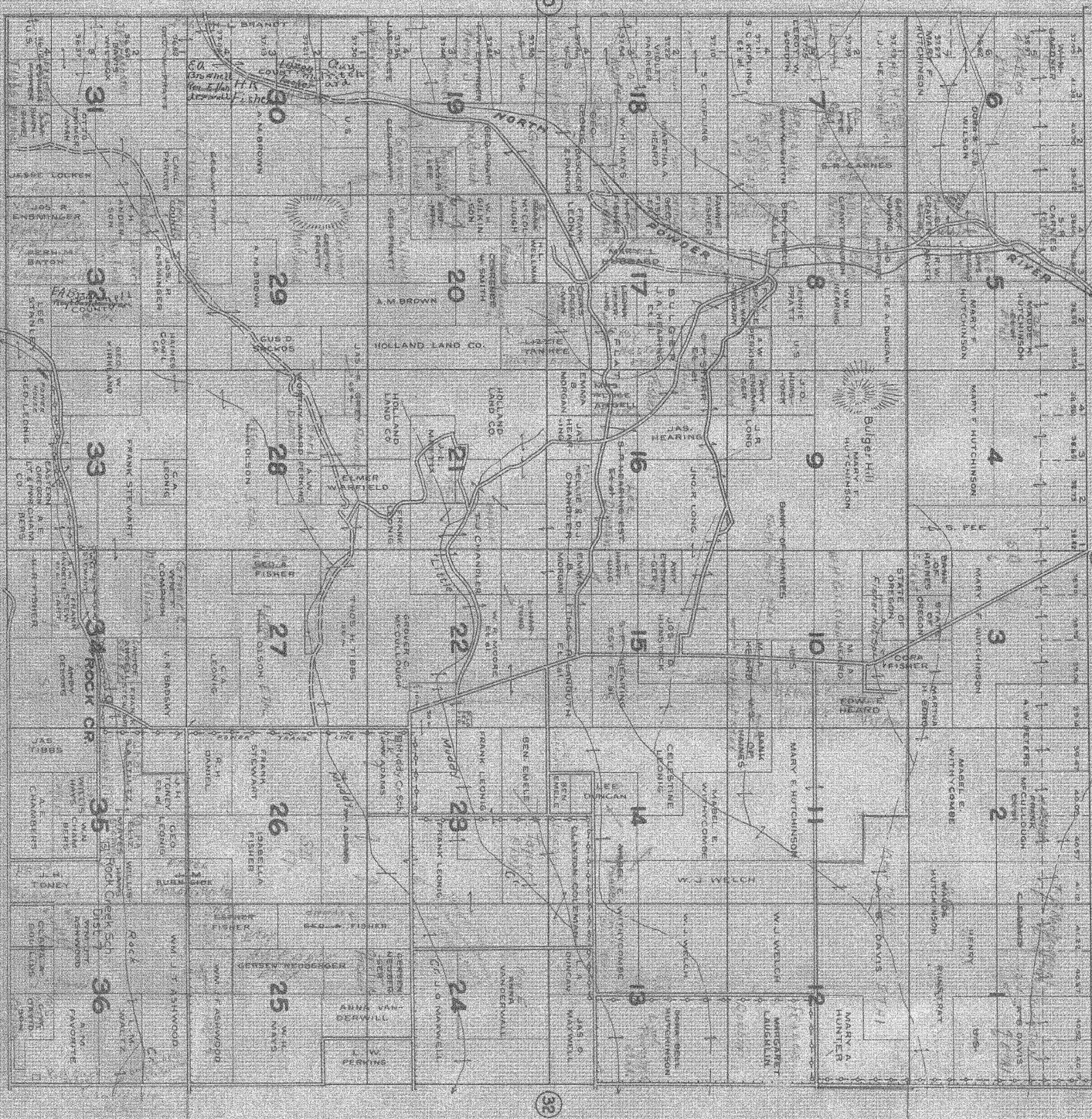

LEGEND

- PAVED ROADS
- STATE HIGHWAYS
- GRAVELED ROADS
- DIRT ROADS
- INTERIOR ROADS
- RAILROADS
- TRAILS
- INTERMITTENT CREEKS
- SCHOOLS